

Michael Brown
Michael Brown Planning Strategies
PO Box 295
Camden NSW 2570

Ref/Job No: 12WOLECO-0005

19/10/2012

Dear Michael,

RE: Hollow Bearing Trees at Paling Court, Centennial Aged Care Facility, Grasmere.

Between February and June this year, we carried out a full tree survey and ecological assessment of the Paling Court Residential Aged Care Facility proposal at Werombi Road Grasmere within the Centennial Aged Care Facility. The arborist found during his survey that there were two individual trees which contained hollows, tree ID 231 a *Eucalyptus moluccana* and tree ID 232 a *Eucalyptus tereticornis* (shown in figure 1 attached, the ELA Arborist Report and in the ELA Ecological Assessment Report). The landscape concept masterplan for the site indicates the trees which are to be removed, the two hollow bearing trees are **not** marked for removal (refer to figure 2 attached). Therefore there will be no hollow bearing tree removal within the Paling Court development site.

If you have any further queries please don't hesitate to contact me on 4201 2207

Kind regards,



Katherine Lang
Environmental Consultant



Figure 1. Vegetation Communities and Hollow Bearing Tree Locations

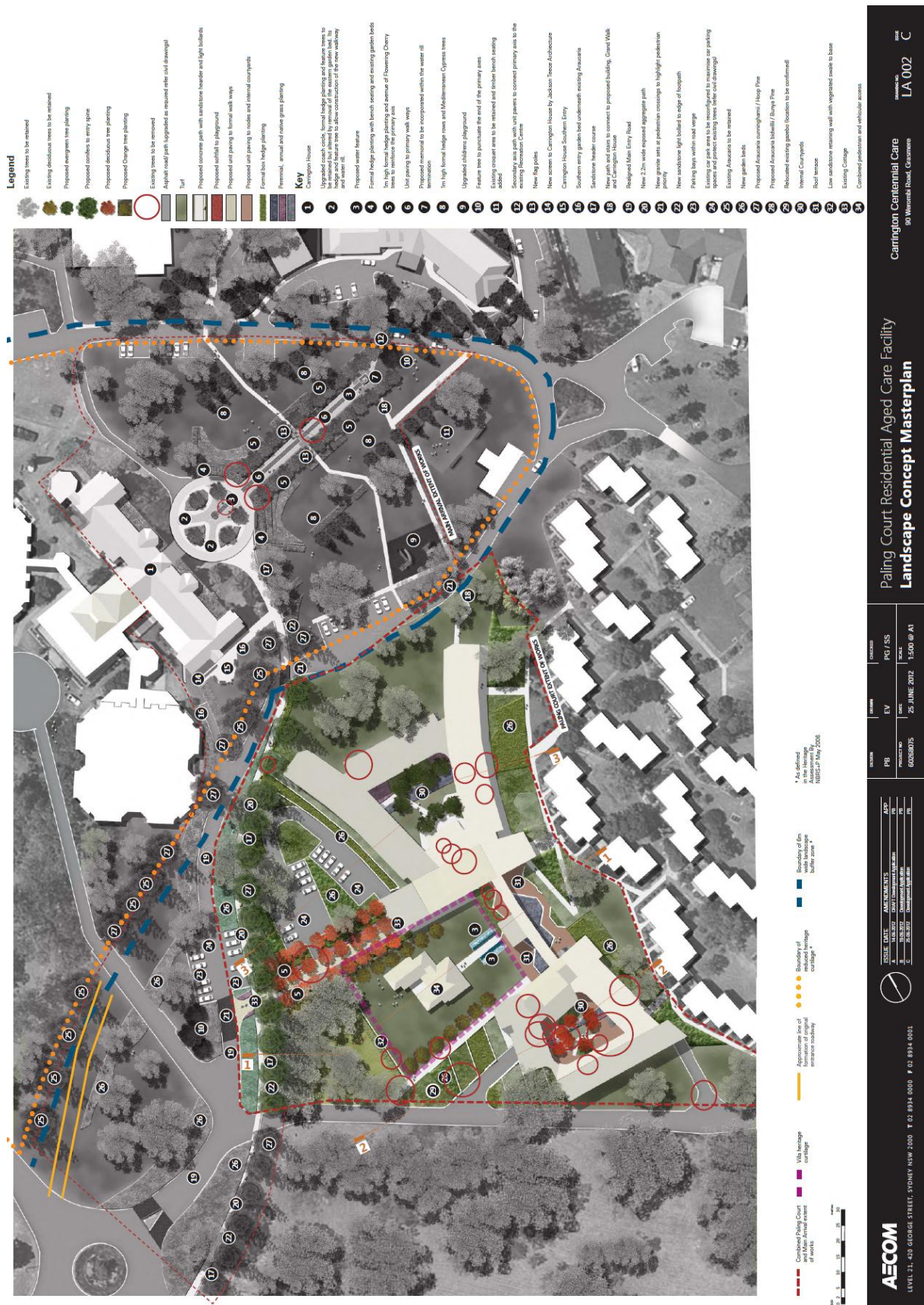

Figure 2. Landscape Masterplan (source AECOM June 2012)